

## KRB10 HOLE IN ONE BENCH TOP BIN INSTALLATION GUIDE

- 1) Mark position and cut 210mm dia hole through bench top.
- 2) Slip rim through hole and screw the 3 brackets onto bottom of rim, using the 3 M4 x 20mm long screws (supplied).
- 3) Through the bracket screw the 3 M4 x 35mm long adjustment screws (supplied). Tighten screws to pull down rim (**Do not over tighten**).

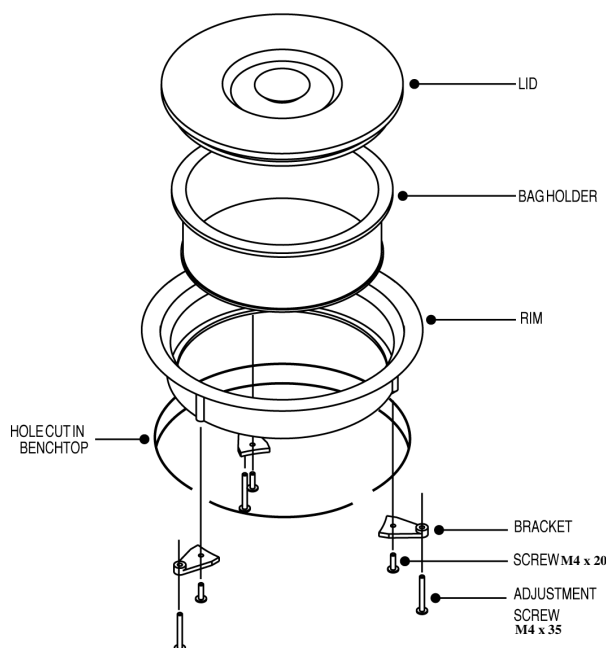

If the use of a bag is desired;

To fit bag, follow sketches below using small to medium garbage bags;

- 1) Fig. 1 Slip bag over bottom of bag holder.
- 2) Fig. 2 Pinch bag tight around holder and fold excess around.
- 3) Fig. 3 Stretch rubber strap and place over bag and bag holder to secure bag.

Slip bag through top of rim and feed through until bag holder sits on bottom edge of rim body. Bottom of bag should be supported in an appropriate sized bucket.

