

KIMBERLEY

Making quality products in Australia

Kimberley Products Pty Ltd

5 Abbots Road, Dandenong South, Vic 3175

Ph: (03) 9768 -5777 Fax: (03) 9768 -5788

www.kimprod.com.au

KRB07 CONCEALED DOOR MOUNTED BIN INSTALLATION INSTRUCTIONS

PARTS LIST:

- 1 Lid Bracket (SKRB07-02N)
- 1 Lid (SKRB07-01)
- 1 Bucket (SKRB06W)
- 1 Eye Hook (HW8)
- 1 Nylon Cord (HW14)
- 1 Instruction Sheet
- 6 x 8 Gauge 1/2 panhead screws (HW33)

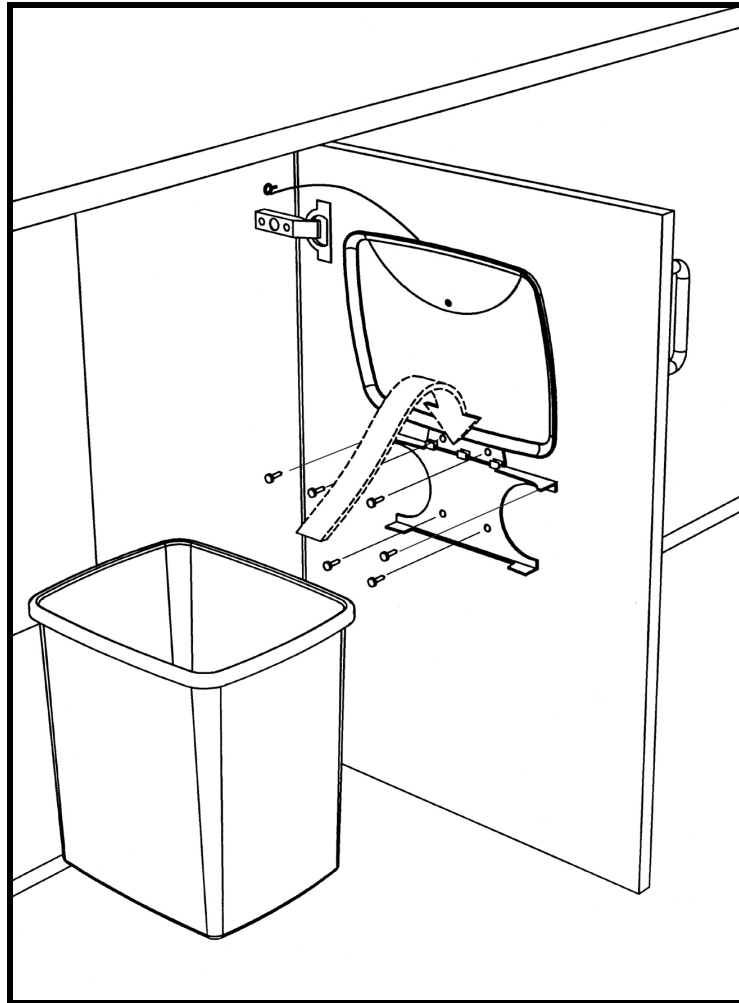

- 1) Click lid into clasps on lid bracket. Clasps located at arrow head of sketch above (Just above part number on lid bracket).
- 2) Establish desired position of bin, allowing clearance for lid movement.
- 3) Mark screw holes through bracket. Drill (6) 2mm holes, being careful there is enough thickness on door panel so drill or screws do not penetrate front surface. Screw in place.
- 4) Feed nylon cord through hole in lid and tie knot. Tie other end to eye screw keeping cord approx level with top of open lid as per sketch. Check movement with door.
- 5) Slide the bin body onto hangers as per sketch.
NB: Plastic liners may be used if desired.